



LIGHTBARS

BEACONS

MINIBARS

DIRECTIONALS

WORKLAMPS

SIRENS

SPEAKERS

SWITCHES

AUXILIARY



MANUFACTURED IN THE UNITED KINGDOM



Bullitt BX31 Directional LED



Redtronic's BX31 directional LED's are ultra-bright, versatile warning lights. They are part of the Bullitt family and are available in 4 sizes including single and double stack, making them the ideal solution for a wide variety of vehicle applications within the emergency and safety services. The BX31 is available in single, tri and multi-colour options and feature R65 Class I output, EMC/R10 approval, IP69K rating, CAP168/ICAO approval for airport use, wide angle optics, synchronisation with other units for simultaneous or alternating operation, 10 flash patterns, it comes with a black bezel as standard (white option available SP_B31BEZ-W) and a 5-year warranty.

Part Number	Colour	Voltage	Stack Type	Bezel	LEDs
BX31AC/BK		11-30VDC	Single	Black	3
BX31BC/BK		11-30VDC	Single	Black	3
BX31TAWB/BK		11-30VDC	Single	Black	9
BX31TRWB/BK		11-30VDC	Single	Black	9
BX31M/BK		11-30VDC	Single	Black	9

Features and Benefits



- Wide-Angle FX Optics
- Ultra-strong UV stabilised polycarbonate lens
- Ultra-bright latest generation LED's
- Colourless when not illuminated
- R65 class I approved (blue & amber)
- EMC / R10 compliant
- CAP168/ICAO airport flash
- IP69K protection against dust & water ingress
- Mounting: 2 screw or L-bracket (optional)
- Black bezel (standard), white (optional)
- Night & day (dim mode)
- 10 flash patterns
- Multiple unit synchronisation
- Cruise feature available
- Weight 59g
- Voltage 11-30VDC
- Current draw @12VDC: 500mA
- LED Power: single (9w), tri (27w), multi (27w)
- Operating temperature -40°c to +105°c
- Warranty: 5 Years

Dimensions

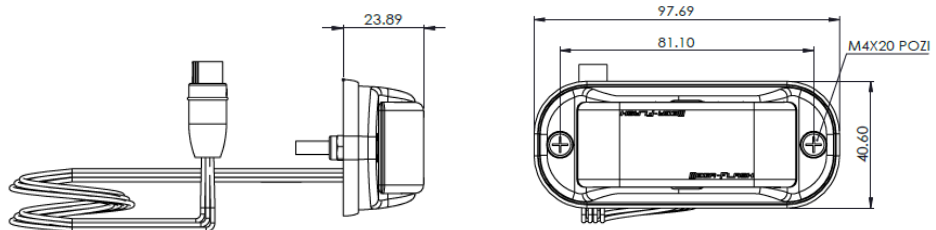

+44 (0)1422 310999

INFO@REDTRONIC.CO.UK

WWW.REDTRONIC.CO.UK